

## SELECT COMMITTEES

### Committee on Committees

*Chair:* Sen. Tom Hansen; *V. Chair:* Sen. Gwen Howard  
 1st District: Sens. Adams, Campbell, Conrad, Langemeier  
 2nd District: Sens. Ashford, Cornett, Howard, Lathrop  
 3rd District: Sens. Carlson, Fischer, Flood, Louden

### Enrollment and Review

*Chair:* Sen. Tyson Larson

### Reference

*Chair:* Sen. John Wightman; *V. Chair:* Sen. John Nelson  
*Members:* Sens. Christensen, Fischer, Flood, Karpisek, Langemeier, Lathrop, Pahls, Heidemann (nonvoting ex officio)

### Rules

*Chair:* Sen. Scott Lautenbaugh  
*Members:* Sens. Brasch, Dubas, Lathrop, Schilz, Flood (ex officio)

## SPECIAL COMMITTEES

### Building Maintenance

*Chair:* Sen. LeRoy Louden; *V. Chair:* Sen. Tom Hansen  
*Members:* Sens. Heidemann, Mello, Sullivan, Wallman

### Education Commission of the States

*Members:* Sens. Adams, Harms, Howard

### Executive Board of the Legislative Council

*Chair:* Sen. John Wightman; *V. Chair:* Sen. John Nelson  
*Members:* Sens. Christensen, Fischer, Flood, Karpisek, Langemeier, Lathrop, Pahls, Heidemann (nonvoting ex officio)

### Legislative Performance Audit

*Chair:* Sen. John Harms; *V. Chair:* Sen. Heath Mello  
*Members:* Sens. Dubas, Flood, Heidemann, Krist, Wightman

### Legislature's Planning

*Chair:* Sen. John Harms; *V. Chair:* Sen. Mike Gloor  
*Members:* Sens. Cook, Flood, Heidemann, Mello, Schumacher, Sullivan, Wightman

### Midwestern Higher Education Commission (Midwest Compact)

*Members:* Sens. Adams, Fischer

### Midwest Interstate Passenger Rail Compact

*Members:* Sens. Cornett, Fischer

### State-Tribal Relations

*Chair:* Sen. Scott Price; *V. Chair:* Sen. Annette Dubas  
*Members:* Sens. Bloomfield, Brasch, Coash, Larson, Nordquist

## CAPITOL HEARING ROOMS



First Floor

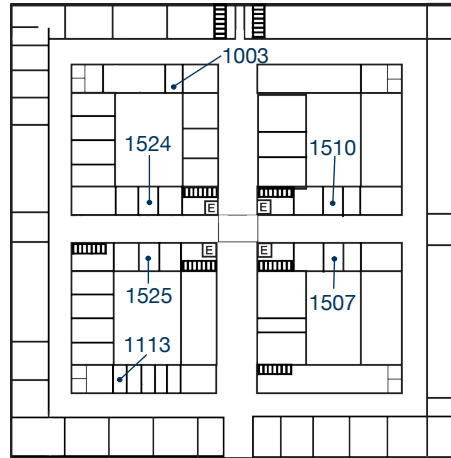

Second Floor

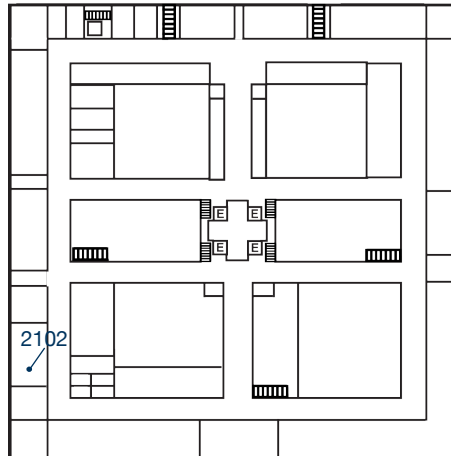

NEBRASKA LEGISLATURE  
 Senators and Committees

2012

Published January 2012  
 Unicameral Information Office  
 Clerk of the Nebraska Legislature  
 State Capitol  
 P.O. Box 94604  
 Lincoln, NE 68509  
 (402) 471-2788  
[www.nebraskalegislature.gov](http://www.nebraskalegislature.gov)

# — NEBRASKA LEGISLATURE 2012 —

**Sen. Greg L. Adams**  
District 24  
P.O. Box 94604  
Lincoln, NE 68509  
(402) 471-2756  
Room 1107

**Sen. Tom Carlson**  
District 38  
P.O. Box 94604  
Lincoln, NE 68509  
(402) 471-2732  
Room 1022

**Sen. Brenda Council**  
District 11  
P.O. Box 94604  
Lincoln, NE 68509  
(402) 471-2612  
Room 1210

**Sen. Ken Haar**  
District 21  
P.O. Box 94604  
Lincoln, NE 68509  
(402) 471-2673  
Room 1017

**Sen. Gwen Howard**  
District 9  
P.O. Box 94604  
Lincoln, NE 68509  
(402) 471-2723  
Room 1124

**Sen. Tyson Larson**  
District 40  
P.O. Box 94604  
Lincoln, NE 68509  
(402) 471-2801  
Room 1019

**Sen. Heath Mello**  
District 5  
P.O. Box 94604  
Lincoln, NE 68509  
(402) 471-2710  
Room 1206

**Sen. Ken Schilz**  
District 47  
P.O. Box 94604  
Lincoln, NE 68509  
(402) 471-2616  
Room 1202

**Sen. John M. Wightman**  
District 36  
P.O. Box 94604  
Lincoln, NE 68509  
(402) 471-2642  
Room 2010

**Sen. Brad Ashford**  
District 20  
P.O. Box 94604  
Lincoln, NE 68509  
(402) 471-2622  
Room 1103

**Sen. Mark Christensen**  
District 44  
P.O. Box 94604  
Lincoln, NE 68509  
(402) 471-2805  
Room 1000

**Sen. Annette M. Dubas**  
District 34  
P.O. Box 94604  
Lincoln, NE 68509  
(402) 471-2630  
Room 1018

**Sen. Galen Hadley**  
District 37  
P.O. Box 94604  
Lincoln, NE 68509  
(402) 471-2726  
Room 2104

**Sen. Charlie Janssen**  
District 15  
P.O. Box 94604  
Lincoln, NE 68509  
(402) 471-2625  
Room 1403

**Sen. Steve Lathrop**  
District 12  
P.O. Box 94604  
Lincoln, NE 68509  
(402) 471-2623  
Room 2000

**Sen. John E. Nelson**  
District 6  
P.O. Box 94604  
Lincoln, NE 68509  
(402) 471-2714  
Room 2108

**Sen. Paul Schumacher**  
District 22  
P.O. Box 94604  
Lincoln, NE 68509  
(402) 471-2715  
Room 1019

**Sen. Bill Avery**  
District 28  
P.O. Box 94604  
Lincoln, NE 68509  
(402) 471-2633  
Room 1114

**Sen. Colby Coash**  
District 27  
P.O. Box 94604  
Lincoln, NE 68509  
(402) 471-2632  
Room 2028

**Sen. Deb Fischer**  
District 43  
P.O. Box 94604  
Lincoln, NE 68509  
(402) 471-2628  
Room 1110

**Sen. Tom Hansen**  
District 42  
P.O. Box 94604  
Lincoln, NE 68509  
(402) 471-2729  
Room 1012

**Sen. Russ Karpisek**  
District 32  
P.O. Box 94604  
Lincoln, NE 68509  
(402) 471-2711  
Room 1015

**Sen. Scott Lautenbaugh**  
District 18  
P.O. Box 94604  
Lincoln, NE 68509  
(402) 471-2618  
Room 1021

**Sen. Jeremy Nordquist**  
District 7  
P.O. Box 94604  
Lincoln, NE 68509  
(402) 471-2721  
Room 2004

**Sen. Les Seiler**  
District 33  
P.O. Box 94604  
Lincoln, NE 68509  
(402) 471-2712  
Room 1523

**Sen. Dave Bloomfield**  
District 17  
P.O. Box 94604  
Lincoln, NE 68509  
(402) 471-2716  
Room 1117

**Sen. Danielle Conrad**  
District 46  
P.O. Box 94604  
Lincoln, NE 68509  
(402) 471-2720  
Room 1008

**Sen. Mike Flood**  
District 19  
P.O. Box 94604  
Lincoln, NE 68509  
(402) 471-2929  
Room 2032

**Sen. John N. Harms**  
District 48  
P.O. Box 94604  
Lincoln, NE 68509  
(402) 471-2802  
Room 2011

**Sen. Bob Krist**  
District 10  
P.O. Box 94604  
Lincoln, NE 68509  
(402) 471-2718  
Room 1117

**Sen. LeRoy J. Loudon**  
District 49  
P.O. Box 94604  
Lincoln, NE 68509  
(402) 471-2725  
Room 1016

**Sen. Rich Pahls**  
District 31  
P.O. Box 94604  
Lincoln, NE 68509  
(402) 471-2372  
Room 1401

**Sen. Jim Smith**  
District 14  
P.O. Box 94604  
Lincoln, NE 68509  
(402) 471-2730  
Room 1115

**Sen. Lydia Brasch**  
District 16  
P.O. Box 94604  
Lincoln, NE 68509  
(402) 471-2728  
Room 1529

**Sen. Tanya Cook**  
District 13  
P.O. Box 94604  
Lincoln, NE 68509  
(402) 471-2727  
Room 1208

**Sen. Tony Fulton**  
District 29  
P.O. Box 94604  
Lincoln, NE 68509  
(402) 471-2734  
Room 2107

**Sen. Burke Harr**  
District 8  
P.O. Box 94604  
Lincoln, NE 68509  
(402) 471-2722  
Room 1115

**Sen. R. Paul Lambert**  
District 2  
P.O. Box 94604  
Lincoln, NE 68509  
(402) 471-2613  
Room 1522

**Sen. Beau McCoy**  
District 39  
P.O. Box 94604  
Lincoln, NE 68509  
(402) 471-2885  
Room 1404

**Sen. Pete Pirsch**  
District 4  
P.O. Box 94604  
Lincoln, NE 68509  
(402) 471-2621  
Room 1101

**Sen. Kate Sullivan**  
District 41  
P.O. Box 94604  
Lincoln, NE 68509  
(402) 471-2631  
Room 1118

**Sen. Kathy Campbell**  
District 25  
P.O. Box 94604  
Lincoln, NE 68509  
(402) 471-2731  
Room 1402

**Sen. Abbie Cornett**  
District 45  
P.O. Box 94604  
Lincoln, NE 68509  
(402) 471-2615  
Room 1116

**Sen. Mike Gloor**  
District 35  
P.O. Box 94604  
Lincoln, NE 68509  
(402) 471-2617  
Room 2015

**Sen. Lavon Heidemann**  
District 1  
P.O. Box 94604  
Lincoln, NE 68509  
(402) 471-2733  
Room 1004

**Sen. Chris Langemeier**  
District 23  
P.O. Box 94604  
Lincoln, NE 68509  
(402) 471-2719  
Room 1210

**Sen. Amanda McGill**  
District 26  
P.O. Box 94604  
Lincoln, NE 68509  
(402) 471-2610  
Room 1212

**Sen. Scott Price**  
District 3  
P.O. Box 94604  
Lincoln, NE 68509  
(402) 471-2627  
Room 1528

**Sen. Norm Wallman**  
District 30  
P.O. Box 94604  
Lincoln, NE 68509  
(402) 471-2620  
Room 1406

## — STANDING COMMITTEES —

### Agriculture

*Chair:* Sen. Tom Carlson; *V. Chair:* Sen. Norm Wallman

*Members:* Sens. Bloomfield, Brasch, Harr, B., Karpisek, Larson, Lathrop  
**2nd floor - Room 2102 - Tues.**

### Appropriations

*Chair:* Sen. Lavon Heidemann; *V. Chair:* Sen. John Harms

*Members:* Sens. Conrad, Fulton, Hansen, Mello, Nelson, Nordquist, Wightman  
**1st floor - Room 1524 - Mon. & Tues.**  
**1st floor - Room 1003 - Wed., Thurs. & Fri.**

### Banking, Commerce and Insurance

*Chair:* Sen. Rich Pahls; *V. Chair:* Sen. Beau McCoy

*Members:* Sens. Christensen, Gloor, Langemeier, Pirsch, Schilz, Schumacher  
**1st floor - Room 1507 - Mon. & Tues.**

### Business and Labor

*Chair:* Sen. Steve Lathrop; *V. Chair:* Sen. Tanya Cook

*Members:* Sens. Ashford, Carlson, Harr, B., Smith, Wallman  
**2nd floor - Room 2102 - Mon.**

### Education

*Chair:* Sen. Greg Adams; *V. Chair:* Sen. Gwen Howard

*Members:* Sens. Avery, Cornett, Council, Haar, K., Seiler, Sullivan  
**1st floor - Room 1525 - Mon. & Tues.**

### General Affairs

*Chair:* Sen. Russ Karpisek; *V. Chair:* Sen. Bob Krist

*Members:* Sens. Bloomfield, Brasch, Coash, Lambert, Larson, McGill  
**1st floor - Room 1510 - Mon.**

### Government, Military and Veterans Affairs

*Chair:* Sen. Bill Avery; *V. Chair:* Sen. Scott Price

*Members:* Sens. Janssen, Karpisek, Pahls, Seiler, Sullivan, Wallman  
**1st floor - Room 1507 - Wed., Thurs. & Fri.**

### Health and Human Services

*Chair:* Sen. Kathy Campbell; *V. Chair:* Sen. Mike Gloor

*Members:* Sens. Bloomfield, Cook, Howard, Krist, Lambert  
**1st floor - Room 1510 - Wed., Thurs. & Fri.**

### Judiciary

*Chair:* Sen. Brad Ashford; *V. Chair:* Sen. Steve Lathrop

*Members:* Sens. Coash, Council, Harr, B., Larson, Lautenbaugh, McGill  
**1st floor - Room 1113 - Wed., Thurs. & Fri.**

### Natural Resources

*Chair:* Sen. Chris Langemeier; *V. Chair:* Sen. Ken Schilz

*Members:* Sens. Carlson, Christensen, Dubas, Haar, K., McCoy, Smith  
**1st floor - Room 1525 - Wed., Thurs. & Fri.**

### Nebraska Retirement Systems

*Chair:* Sen. Jeremy Nordquist; *V. Chair:* Sen. LeRoy Loudon

*Members:* Sens. Heidemann, Karpisek, Lambert, Mello  
**1st floor - Room 1525 - At the call of the chairperson**

### Revenue

*Chair:* Sen. Abbie Cornett; *V. Chair:* Sen. LeRoy Loudon

*Members:* Sens. Adams, Brasch, Fischer, Hadley, Pirsch, Schumacher  
**1st floor - Room 1524 - Wed., Thurs. & Fri.**

### Transportation and Telecommunications

*Chair:* Sen. Deb Fischer; *V. Chair:* Sen. Galen Hadley

*Members:* Sens. Campbell, Dubas, Janssen, Lautenbaugh, Loudon, Price  
**1st floor - Room 1113 - Mon. & Tues.**

### Urban Affairs

*Chair:* Sen. Amanda McGill; *V. Chair:* Sen. Colby Coash

*Members:* Sens. Ashford, Cook, Krist, Lambert, Smith  
**1st floor - Room 1510 - Tues.**